

SITE PLAN LEGEND:

○ LS	POLE MOUNTED LIGHT STANDARD AS PER ELEC. DWGS
---	PROPERTY LINE / EXTENT OF CONTRACT
- - -	PART LOT / EASEMENT LINE
- - - -	FIRE ACCESS ROUTE
▭	BENCH AS PER LANDSCAPE DWGS
▭	BIKE RACK AS PER LANDSCAPE DWGS
▭	PICNIC TABLE AS PER LANDSCAPE DWGS
○ MH	MANHOLE AS PER CIVIL DWGS
□ CB	CATCH BASIN AS PER CIVIL DWGS
○ CB	CATCH BASIN / MANHOLE AS PER CIVIL DWGS
○ FH	FIRE HYDRANT AS PER CIVIL DWGS
○ BOLL	METAL BOLLARD
○	POST MOUNTED SIGN
○	BORERHOLE LOCATION
IB / SIB	IB / SIB PER SURVEY
800	BARRIER FREE CUT CURB
TDB	TRAFFIC CALMING BUMP
▭	ASPHALT PAVEMENT
▭	CONCRETE PAVING / SIDEWALK
▭	GRAVEL PATH
▭	LIGHT-DUTY ASPHALT
▭	MEDIUM-DUTY ASPHALT
▭	HEAVY-DUTY ASPHALT
▭	GRASS / SOG

- SITE PLAN GENERAL NOTES:**
- THE CONTRACTOR SHALL BE RESPONSIBLE FOR THE EXTENT OF CONTRACT LINE INDICATED ON THE SITE PLAN PLUS ANY WORK SPECIFICALLY NOTED OUTSIDE OF THE LINE. ALL WORK DONE OUTSIDE OF THESE LIMITS MUST BE EXECUTED IN STRICT ACCORDANCE WITH THE SPECIFICATIONS OF THE CONTRACT AND ALL OTHER APPLICABLE MUNICIPAL BY-LAWS. MAKE SURE TO ADDITIONAL COST TO THE OWNER OR MUNICIPALITY ANY DAMAGE CAUSED BY THE CONSTRUCTION TO MATERIALS OR FINISHES BEYOND THE EXTENT OF CONTRACT LINE.
 - CONTRACTOR IS TO RESTRICT ALL WORK, EQUIPMENT, AND MATERIALS STORAGE TO AREAS WITHIN THE EXTENT OF CONTRACT LINE EXCEPT WHERE NOTED OTHERWISE. PRIMARY SITE ACCESS POINTS & CONSTRUCTION PARKING IS TO BE CONFIRMED WITH BOLLARD, NO PARKING IN MUNICIPALITY RIGHT-OF-WAY.
 - LOCATE EXCAVATED MATERIALS & TOPSOIL PILES AS DIRECTED. AT COMPLETION OF PROJECT ANY EXCESS MATERIAL IS TO BE REMOVED AND AREA MADE GOOD TO PROJECT'S SATISFACTION.
 - FOR TRENCHING & BACKFILLING OF ALL SERVICE LINES AND DIVISION OF RESPONSIBILITY, REFER TO APPROPRIATE SECTIONS IN SPECIFICATIONS.
 - SUPPLY AND INSTALL TRENCHING TO THICKNESS SPECIFIED OVER ALL BORED AND PILE-DRIVEN AREAS INDICATED ON DRAWINGS. PROVIDE ADDITIONAL TOPSOIL AS REQUIRED OVER AND ABOVE TOPSOIL TAKEN FROM SITE. PROVIDE SCODING TO AREAS INDICATED AND TERMINATE AT EXTENT OF CONTRACT LINE. EXTEND SCODING BEFORE PROPERTY LINES TO ROADWAYS WHERE INDICATED.
 - NOTE THAT EXACT LOCATIONS OF ALL NEW MECHANICAL & ELECTRICAL ITEMS ARE APPROXIMATE UNLESS DIMENSIONS GIVEN. ADJUST LOCATION AS REQUIRED AND AS APPROVED BY CONSULTANT TO SUIT SITE CONDITIONS.
 - NOTE THAT ALL MECHANICAL AND ELECTRICAL UNDERGROUND SERVICE LINES INDICATED ON DRAWINGS ARE APPROXIMATE ONLY AND ARE INDICATED AS ACCURATELY AS POSSIBLE FROM DIMENSION SUPPLIED. CONTRACTOR SHALL BE RESPONSIBLE FOR DETERMINING EXACT TYPES, LOCATIONS AND DEPTHS OF ALL UNDERGROUND SERVICES IN AREA OF NEW CONSTRUCTION INCLUDING GAS LINES, TELEPHONE, CABLE TV, ETC. BEFORE EXCAVATING.
 - THE CONTRACTOR SHALL BE RESPONSIBLE FOR MAINTAINING ADEQUATE RECORDS OF CONSTRUCTION TO FACILITATE AS-CONSTRUCTED DRAWINGS.
 - REFER TO CIVIL DRAWINGS FOR SITE SERVING AND GRADING, EROSION AND SEDIMENT CONTROL, STORM WATER MANAGEMENT AND DRAINAGE AND ANY OTHER RELATED WORKS.
 - REFER TO LANDSCAPE DRAWINGS FOR PLANTING, SCODING, TREE AND SHRUB LAYOUT, SCHEDULE INCLUDING PRESERVATION AND REMOVAL, PAVED LAYOUTS, SITE AMENITIES, AND ANY OTHER RELATED WORKS.
 - REFER TO M&E DRAWINGS FOR SITE LIGHTING, POWER, CISTERNING AND ANY OTHER RELATED WORKS.
 - CONTRACTOR IS RESPONSIBLE FOR COORDINATION OF ALL DRAWINGS FROM ALL DISCIPLINES. ALL DIMENSIONS ARE TO BE CHECKED AND VERIFIED ON THE JOB. ANY DISCREPANCIES ARE TO BE REPORTED TO THE CONSULTANT. ALL DRAWINGS REMAIN THE PROPERTY OF THE CONSULTANT. ONLY LATEST APPROVED DRAWINGS ARE TO BE USED FOR CONSTRUCTION.

1 Site Plan
A101 1 : 500

Design has been completed to the 2012 OBC. (Drawings were substantially completed before January 1, 2025.)

No.	Revision	Date
1	Issued for Schematic Owner Review	2026-03-05

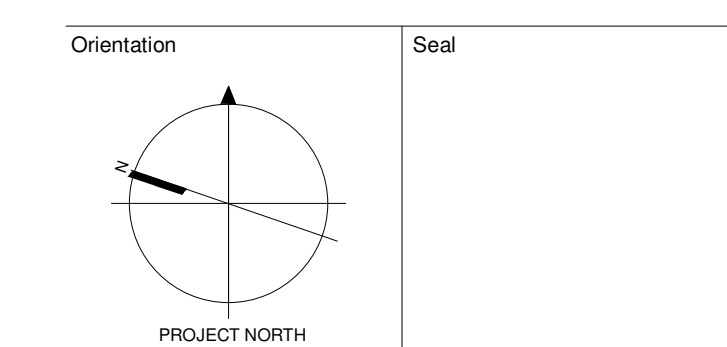

All dimensions to be checked and verified on the job by the Contractor. Any discrepancies are to be reported to the Consultant prior to action. Only the latest approved drawings to be used for construction in conformance with all applicable codes, by-laws and regulations. All drawings remain the property of the Consultant.

© Copyright Reserved:
These drawings and all that is represented herein are the exclusive property of Salter Pilon Architecture Inc. They may not be used or reproduced without written permission from Salter Pilon Architecture Inc.



151 Ferris Lane, Suite 400 Barrie, Ontario L4M 6C1
salterpilon.com t: 705.737.3530

Project Information

Stouffville Aquatics Expansion

Enter address here

For
Owner

Drawing Title
Site Plan

Date	2026-03-05	Project No	25018	Drawing No	A101
Drawn by	Author				
Scale	1 : 500				

Department Legend

- Administration
- Changeroom
- Concession
- Guard Office
- Guard Office and Change Area
- Pool
- Pool Vestibule and Showers
- pUBLIC sPACE
- Re-allocated Space
- Storage and Service
- Viewing Gallery
- Washroom

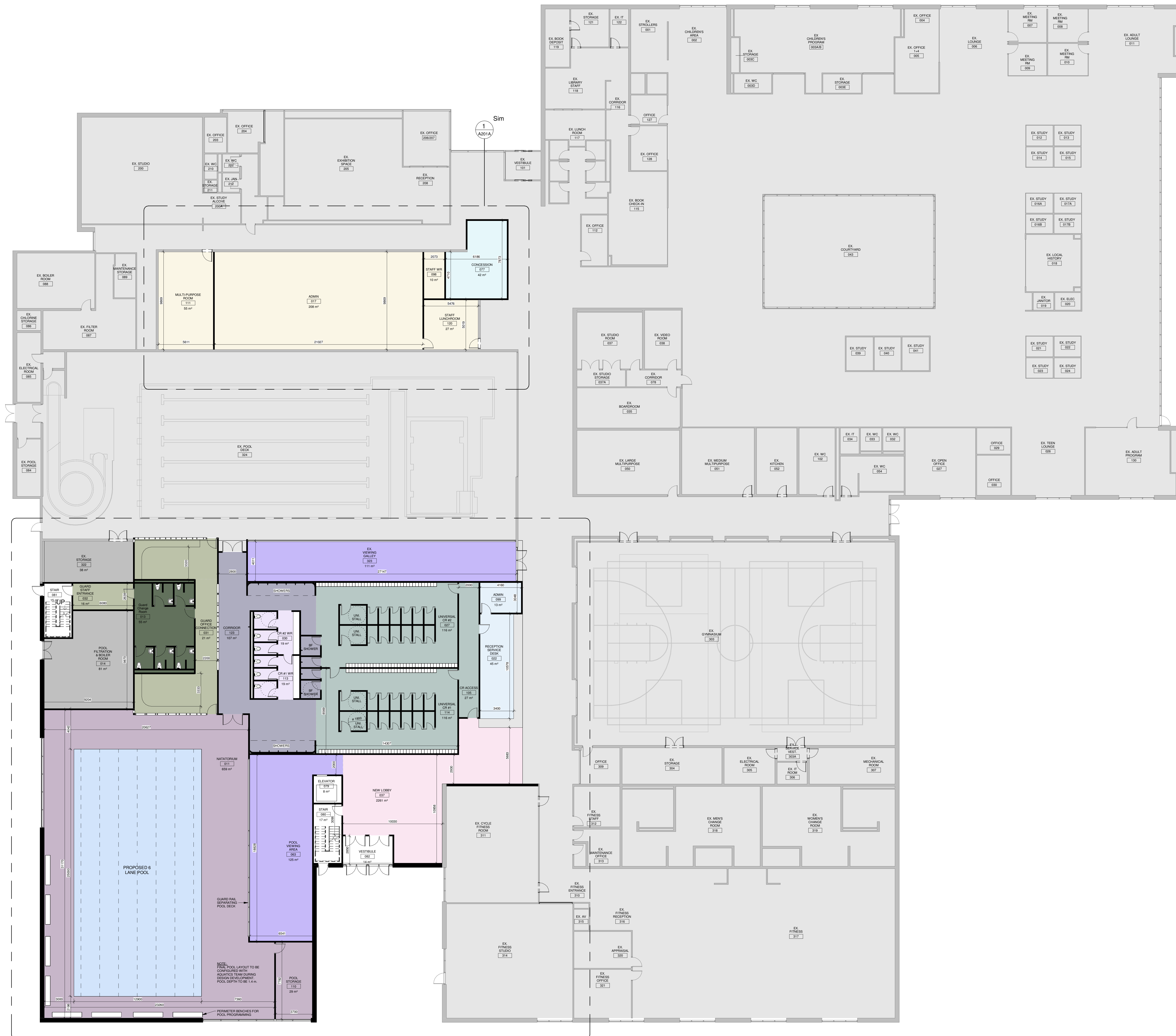

Design has been completed to the 2012 OBC. (Drawings were substantially completed before January 1, 2025.)

No.	Revision	Date
1	Issued for Schematic Owner Review	2026-03-05

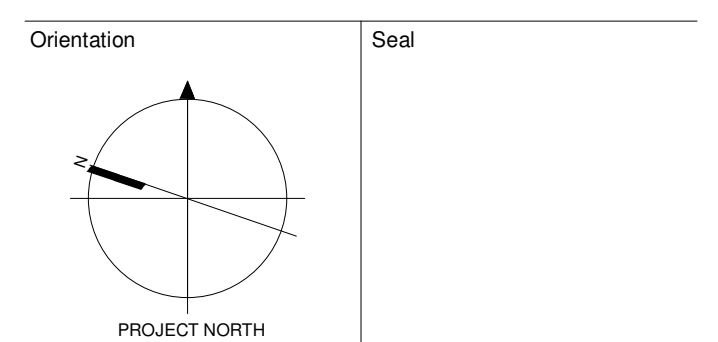

All dimensions to be checked and verified on the job by the Contractor. Any discrepancies are to be reported to the Consultant prior to action. Only the latest approved drawings to be used for construction in conformance with all applicable codes, by-laws and regulations. All drawings remain the property of the Consultant.

© Copyright Reserved:
These drawings and all that is represented herein are the exclusive property of Salter Pilon Architecture Inc. They may not be used or reproduced without written permission from Salter Pilon Architecture Inc.



151 Ferris Lane, Suite 400 Barrie, Ontario L4M 6C1
salterpilon.com t: 705-737-3530

Project Information

Stouffville Aquatics Expansion

Enter address here

For
Owner

Level 1 Floor Plan

Date	2026-03-05	Project No	25018	Drawing No	A2018
Drawn by	Author				
Scale	1 : 150				

1 Level 1 Floor - Full Plan
1 : 150

1 Sim
A2018

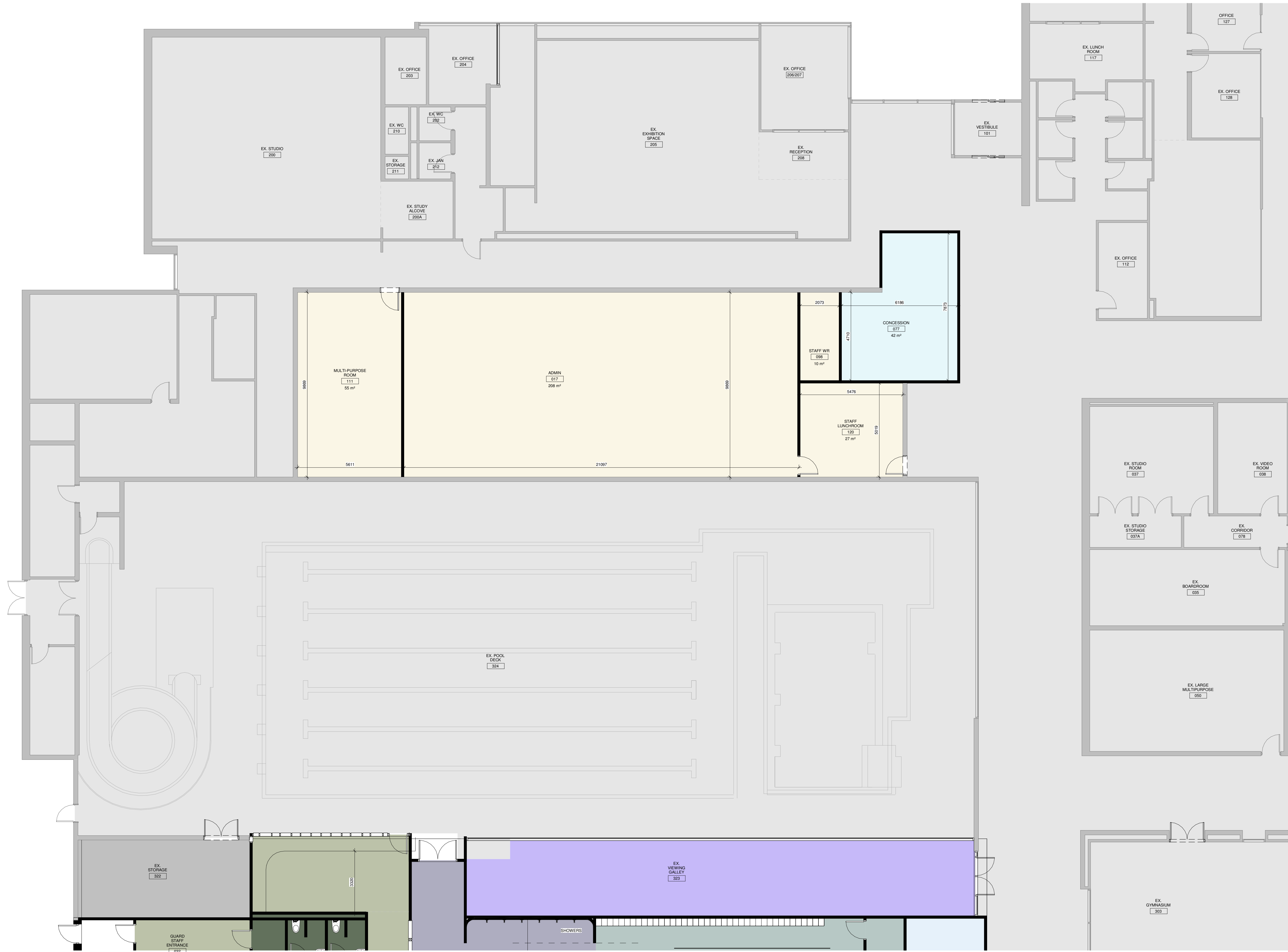

1 Level 1 North - Existing Condition
A201A 1 : 100

Design has been completed to the 2012 OBC. (Drawings were substantially completed before January 1, 2025.)

No.	Revision	Date
1	Issued for Schematic Owner Review	2026-03-05

No.	Revision	Date

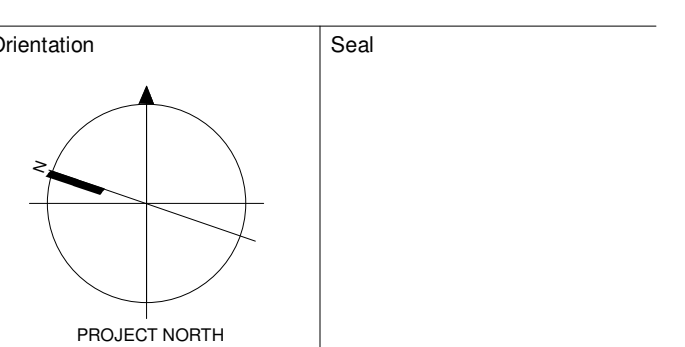

All dimensions to be checked and verified on the job by the Contractor. Any discrepancies are to be reported to the Consultant prior to action. Only the latest approved drawings to be used for construction in conformance with all applicable codes, by-laws and regulations. All drawings remain the property of the Consultant.
© Copyright Reserved: These drawings and all that is represented herein are the exclusive property of Salter Pilon Architecture Inc. They may not be used or reproduced without written permission from Salter Pilon Architecture Inc.

salterpilon
architecture

151 Ferris Lane, Suite 400 Barrie, Ontario L4M 6C1
salterpilon.com t: 705-737-3530

Project Information

Stouffville Aquatics Expansion

Enter address here

For
Owner

Drawing Title
Level 1 Floor Plan - North Existing

Date	2026-03-05	Project No	25018	Drawing No	A201A
Drawn by	Author				
Scale	1 : 100				

C:\Users\cdall\OneDrive - Salter Pilon Architecture Documents\Schematic Update_Collaborative_P04_cad\IN\B\K\vt 5/2/2026 9:05:19 AM

Department Legend

- Recreation Programming
- Storage and Service
- Washroom

Room Schedule L2 A			
Level	Name	Department	Area
Level 2 Floor Plan	BREAKRM	Washroom	5 sq'
Level 2 Floor Plan	ELEVATOR		6 sq'
Level 2 Floor Plan	MECHANICAL	Storage and Service	26 sq'
Level 2 Floor Plan	STAIR		17 sq'
Level 2 Floor Plan	STAIR		15 sq'
Level 2 Floor Plan	STUDIO SPACE	Recreation Programming	107 sq'
Level 2 Floor Plan	STUDIO SPACE	Recreation Programming	94 sq'
Level 2 Floor Plan	STUDIO SPACE	Recreation Programming	107 sq'
Level 2 Floor Plan	STUDIO SPACE	Recreation Programming	107 sq'
Level 2 Floor Plan	STUDIO SPACE	Recreation Programming	107 sq'
Level 2 Floor Plan	STUDIO STORAGE	Recreation Programming	34 sq'
Level 2 Floor Plan	STUDIO STORAGE	Recreation Programming	34 sq'
Level 2 Floor Plan	STUDIO STORAGE	Recreation Programming	34 sq'
Level 2 Floor Plan	TRACK & GRASS SPACE	Recreation Programming	287 sq'
Level 2 Floor Plan	WTRM	Washroom	4 sq'
Level 2 Floor Plan	WTRM	Washroom	5 sq'
Level 2 Floor Plan	WTRM	Washroom	5 sq'

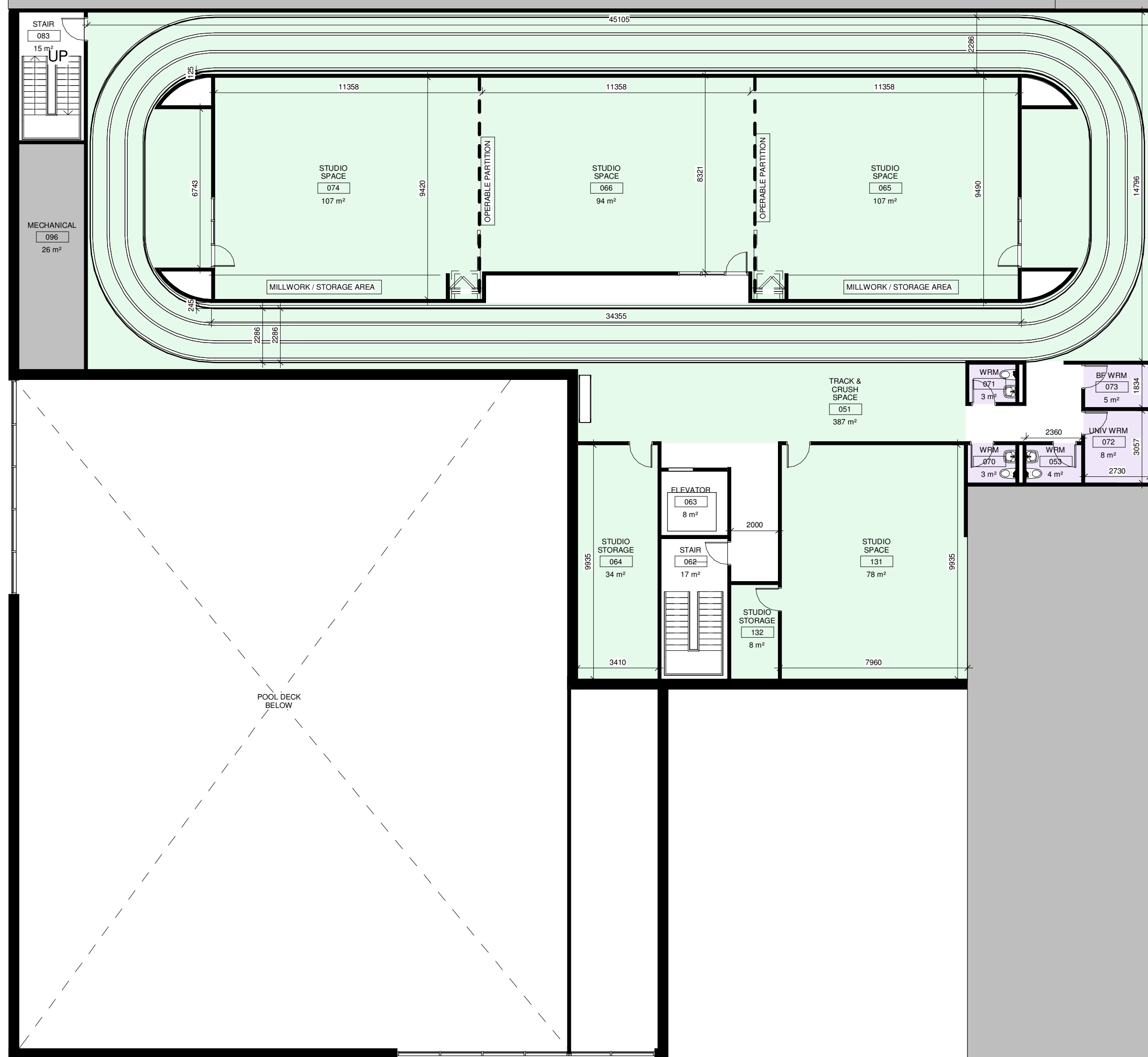

1
A202
Level 2 Floor - Full Plan
1 : 150

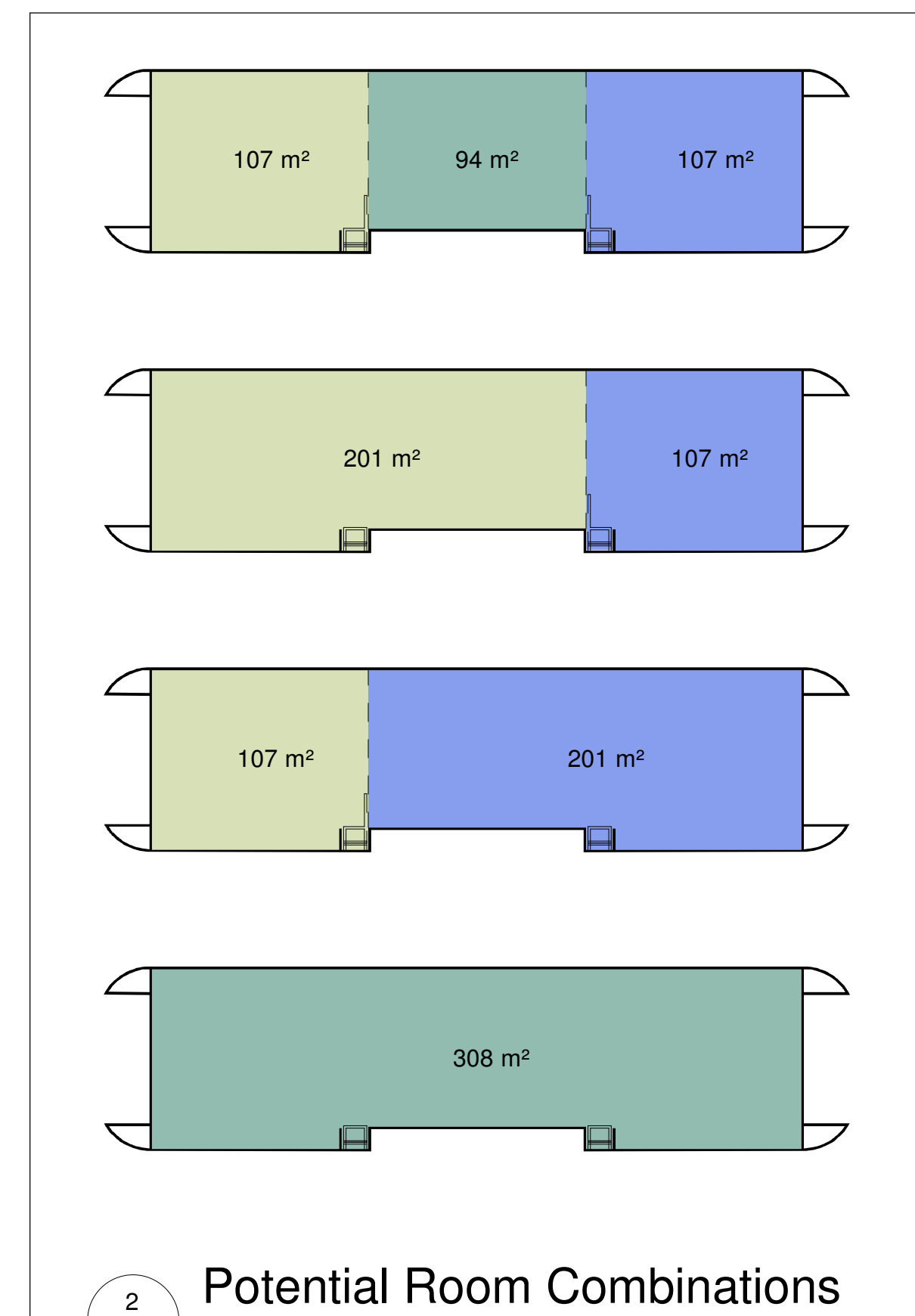

Design has been completed to the 2012 OBC. (Drawings were substantially completed before January 1, 2025.)

No.	Revision	Date
1	Issued for Schematic Owner Review	2026-03-05

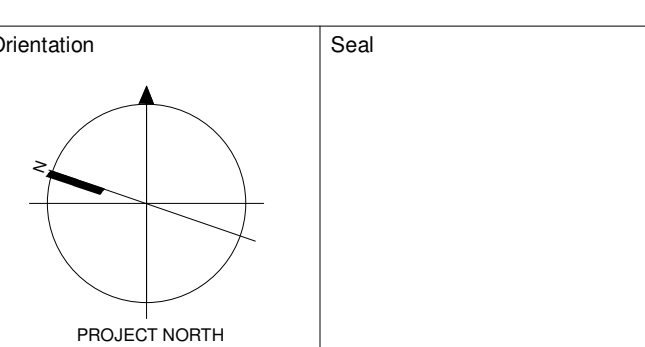

All dimensions to be checked and verified on the job by the Contractor. Any discrepancies are to be reported to the Consultant prior to action. Only the latest approved drawings to be used for construction in conformance with all applicable codes, by-laws and regulations. All drawings remain the property of the Consultant.

© Copyright Reserved:
These drawings and all that is represented herein are the exclusive property of Salter Pilon Architecture Inc.
They may not be used or reproduced without written permission from Salter Pilon Architecture Inc.



151 Ferris Lane, Suite 400 Barrie, Ontario L4M 6C1
salterpilon.com t: 705-737-3530

Project Information
Stouffville Aquatics Expansion
Enter address here
For
Owner
Drawing Title
Level 2 Floor Plan

Date	Project No	Drawing No
2026-03-05	25018	A202
Drawn by Author		
Scale As indicated		

